

**Order No. V3070FF • Description: NO HARDWATER BYPASS 1/125 F-F or
Order No. V3070FM • Description: NO HARDWATER BYPASS 1/125 F-M**

Clack Item Number	Software Minimum Rev Level	Before using V3070FF or V3070FM with EE, EI, or CI valves, press and hold NEXT and REGEN to verify that the software has the minimum rev level shown in the table.
V3408EE-01BOARD	513.7	
V3408EI-01BOARD	613.5	
V3108CI-02BOARD	316.9	

Plan the position of the no hard water bypass valve and control valve carefully because of the following:

- The 8' no hard water bypass valve motor cable must be threaded through the back plate and connected to the two pin connector labeled DRIVE on the control valve board. Approximately 1' of the cable length should be allowed for weaving through the back plate.
- The 15' AC Adapter cable must be thread through the back plate of the control valve. Approximately 1' of the cable length should be allowed for weaving through the back plate. The AC adapter should be installed to a properly grounded not switched outlet.

Try to allow sufficient slack in cables so cables may be zip tied to plumbing lines to prevent the cables from being accidentally pulled. Where necessary, break out the tab in the back plate to allow two cables to be woven through the same slot in the back plate. No more than two cables may be woven through one back plate slot. To help prevent damage to cables, allow solder joints to cool or solvent cement joints to cure after completing the various service, drain and regenerant plumbing connections. Thread the various cables through the appropriate back plate(s) and connect as described in the bullets above.

Service Water Plumbing Connections

Connect the water service line to the water inlet of control valve.

Connect the outlet of the control valve to the port labeled A on the no hard water bypass valve.

The no hard water bypass valve is open when the threaded portion of the motorized alternating valve drive gear is visible in the clear dome of the cover.

If control valve is in an error state during regeneration mode, the no hard water bypass valve will remain closed until error is corrected and reset.

Caution: No Hard Water Bypass Valve installations prevent water from entering the downstream plumbing. If a downstream plumbing device or local plumbing codes require uninterrupted water supplies, design the installation to accommodate.

If the control valve manual does not include instructions for setting up no hard water bypass software, visit www.clackcorp.com to download the current copy of the instructions.

OPERATING PRESSURES: 20 PSI MINIMUM / 125 PSI MAXIMUM • OPERATING TEMPERATURES: 40°F MINIMUM / 110°F MAXIMUM

Service or Installation of Motor

Do not lubricate the motor or the gears. To install the motor, move the spring clip loop to the right and hold. Gently turn the motor while inserting so that the gear on the motor meshes with the gears under the drive gear cover. Release the spring clip loop and continue to rotate the motor until the wires are horizontal and the motor housing engages the small plastic bulge inside the drive bracket motor retainer. Reconnect the motor plug to the two-pronged jack on the lower left side of the PC board. If the motor will not easily engage with the drive gears when reinstalling, lift and slightly rotate the motor before reinserting.

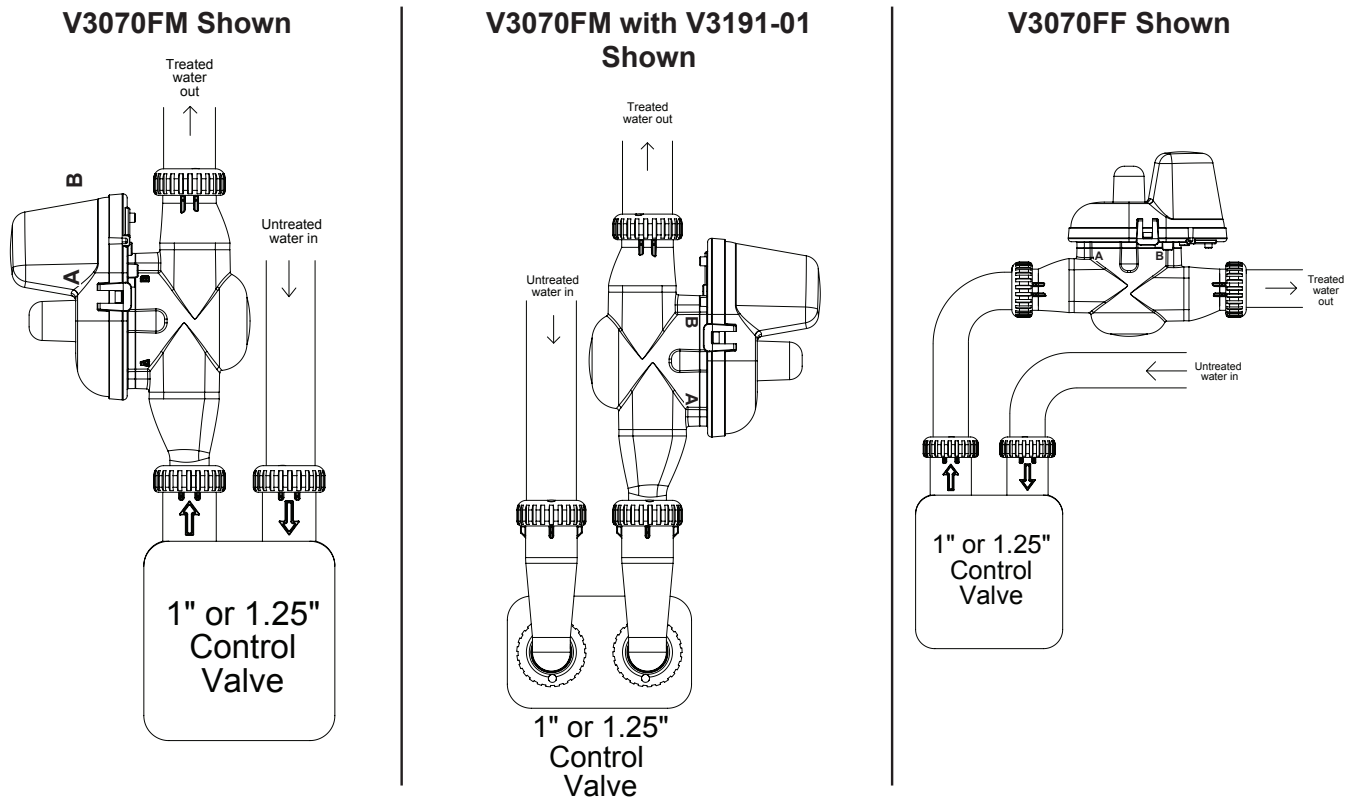

**Order No. V3070FF • Description: NO HARDWATER BYPASS 1/125 F-F or
Order No. V3070FM • Description: NO HARDWATER BYPASS 1/125 F-M**

Drawing No.	Order No.	Description	Quantity	
			V3070FF	V3070FM
1	V3073	MAV/NOHWBY COVER ASY	1	1
2	V3476	WS MOTOR ASY 8 FT	1	1
3	V3592	SCREW #8-3/4 PHPN T-25 SS	3	3
4	V3262-01	WS1.5&2ALT/2BY REDUCGEARCVRASY	1	1
5	V3110	WS1 DRIVE REDUCING GEAR 12X36	3	3
6	V3264	WS2 BYPASS REDUCTION GEAR AXLE	3	3
7	V3527	SCREW 1/4-20 X 3/4 BHSCS SS	4	4
8	V3072	MAV/NOHWBY 1/125/15 DRIVE ASY	1	1
9	V3506-01	MAV/NOHRD 1/125/15 PISTON	1	1
10	V3074	MAV/NOHWBY 1/125/15 STACK ASY	1	1
11	V3521FF	NOHRD WTR BYPASS BODY ASY F-F	1	N/A
12	V3521FM	NOHRD WTR BYPASS BODY ASY F-M	N/A	1
13	V3151	WS1 NUT 1 QC	N/A	1
14	V3150	WS1 SPLIT RING	N/A	1
15	V3105	O-RING 215	N/A	1

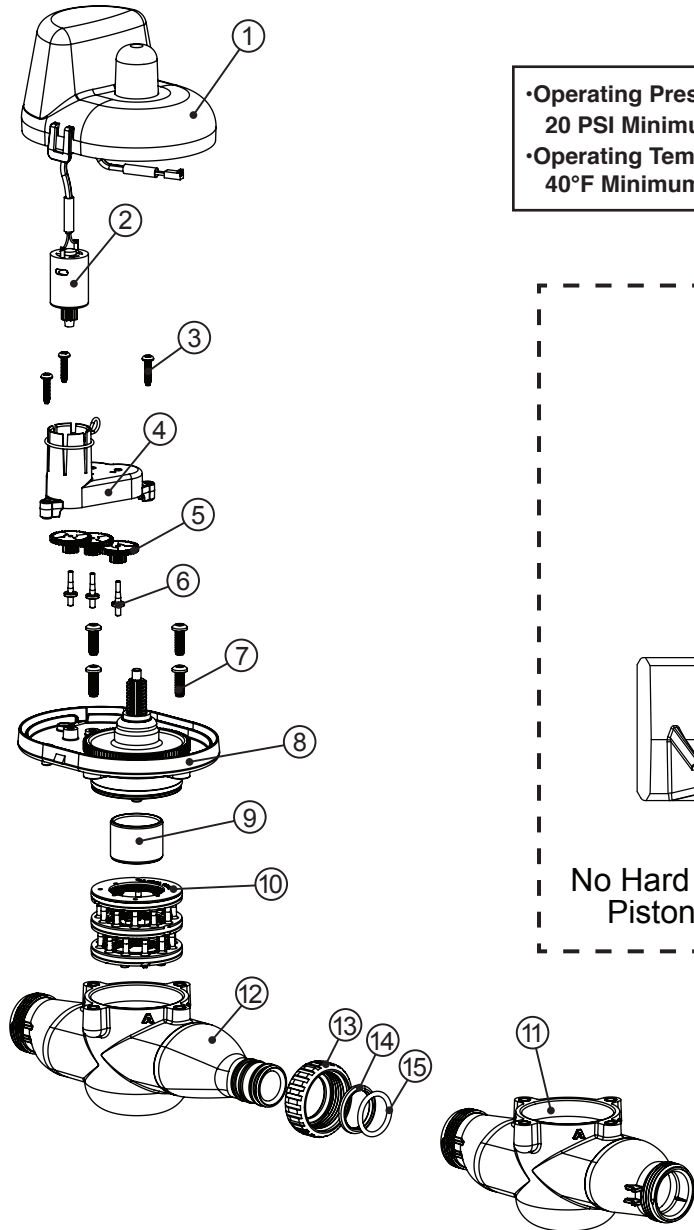

•Operating Pressures:
20 PSI Minimum / 125 PSI Maximum
•Operating Temperatures:
40°F Minimum / 110°F Maximum

